

REVISIONS				
ZONE	REV.	DESCRIPTION	DATE	APPROVED
	A	ADD THROUGH HANDLE	6/14/2019	JMG
	B	DECREASE DIAMETER IN SHEETING AREA TO MATCH EZ-GRAB DELUXE	6/14/2019	JMG
	C	INCREASE GUSSET RIB WIDTH PER RANDY	6/14/2019	JMG
	D	MODEL BOTTOM OF DELINEATOR TO MATCH CSPG#03-740 [EZ-GRAB DELINEATOR]	6/14/2019	JMG
	E	ADJUSTED SHEETING AREA HEIGHT FROM 4.250" TO 4.500"	6/14/2019	JMG
	F	ADJUSTED RINGS TO MATCH CSPG#03-740 [EZ-GRAB DELINEATOR]	6/14/2019	JMG

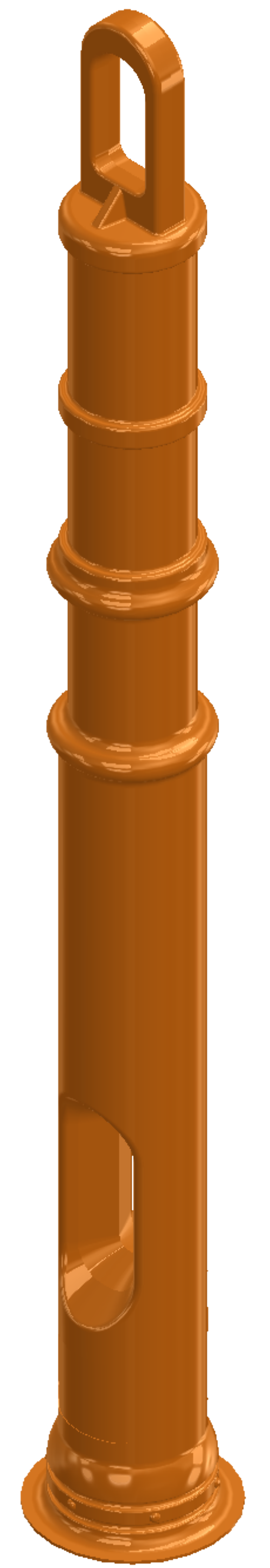

- GENERAL NOTES:**
- 1.) AT .060" TYPICAL WALL THICKNESS, WEIGHT= 528 GRAMS
 - 2.) OTHER MASS PROPERTIES ARE:
 -Density = 15.03 grams per cubic inch
 -Volume = 35.16 cubic inches
 -Surface area = 1172.85 square inches
 - 3.) INTERCHANGEABLE LOGO INSERT, CURRENTLY DISPLAYING CSPG LOGO
 - 4.) MARKETING NAME AND CSPG PART NUMBER TBD LATER

PROPRIETARY AND CONFIDENTIAL
 THE INFORMATION CONTAINED IN THIS
 DRAWING IS THE SOLE PROPERTY OF
 CORTINA SAFETY PRODUCTS GROUP.
 ANY
 REPRODUCTION IN PART OR AS A WHOLE
 WITHOUT THE WRITTEN PERMISSION OF
 CORTINA SAFETY PRODUCTS GROUP IS
 PROHIBITED.

UNLESS OTHERWISE SPECIFIED:		NAME	DATE
DRAWN	SMB	SMB	6/14/19
CHECKED	VEB		
ENG APPR.	JMG		
MFG APPR.	MG		
Q.A.	MS		
COMMENTS:			
INTERPRET GEOMETRIC TOLERANCING PER: ASME 14.5-2017			
MATERIAL	LDPE		
FINISH			
NEXT ASSY	USED ON		
APPLICATION	DO NOT SCALE DRAWING		

Cortina Safety Products

EZ-GRAB DUAL GRIP DELINEATOR POST

SIZE **D** DWG# **SMB-06142019-1** REV **F**

SCALE: 1:4 WEIGHT: SHEET 1 OF 2