

TOP VIEW

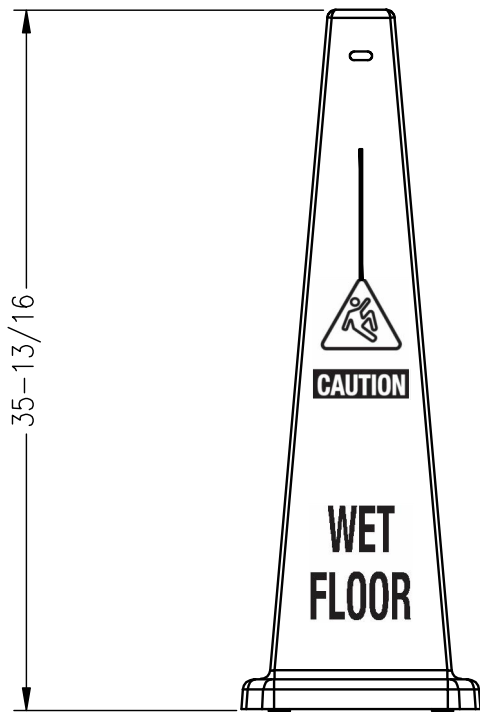

FRONT VIEW

MANY LEGENDS AVAILABLE,  
CONTACT CUSTOMER SERVICE



OPTIONAL BLINKING  
LIGHT LATCHES IN TOP  
OPENING, 2=1 SCALE  
P/N 03-600-32

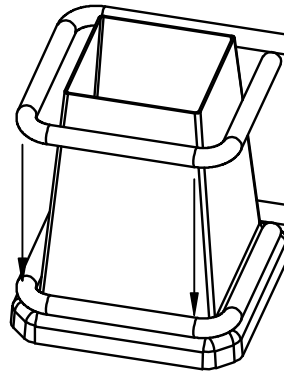

9 LB WEIGHT RING  
P/N 03-600-30  
BLACK METAL

SIMILAR CONE, 25" TALL  
USE P/N 03-600-12WF

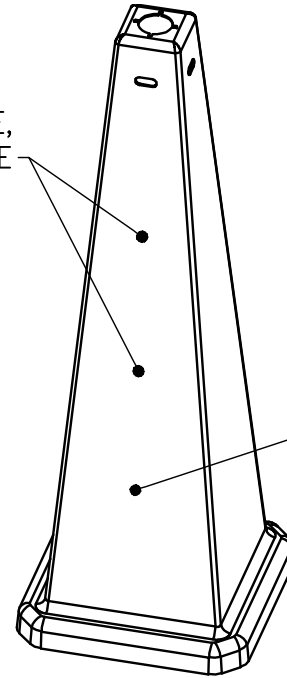

ISOMETRIC VIEW

LOW CENTER  
OF GRAVITY

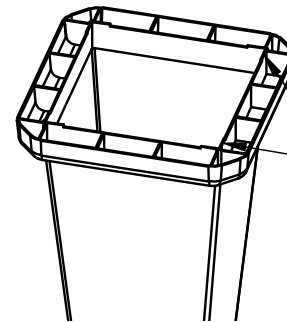

BOTTOM ISOMETRIC

RUGGED INTEGRAL  
CLEATS MOLDED  
INTO THE BASE

REV	REF	REVISION DESCRIPTION	BY	DATE
A	---	RELEASED FOR SALES REPS AND CUSTOMER SERVICE	JIL	7-8-2013
MATERIAL		COLOR AND FINISH	THIRD ANGLE PROJECTION	
DURABLE POLYOLEFIN WEIGHT = 3.8 LB		SAFETY YELLOW IS STANDARD CUSTOM COLORS AVAILABLE		
THIS DRAWING IN DESIGN AND DETAIL IS THE PROPERTY OF CORTINA TOOL & MOLDING COMPANY MATERIAL DESCRIBED AND INFORMATION CONVEYED MAY NOT BE COPIED, DIVULGED TO OTHERS OR USED FOR MANUFACTURING OR ANY OTHER PURPOSE WITHOUT CONSENT		TOLERANCES UNLESS OTHERWISE SPECIFIED		
		2 PLACE DECIMALS ± N/A 3 PLACE DECIMALS ± N/A ANGULAR DIMENSIONS ± N/A		

**Cortina** <sup>A Cortina Company</sup>  
 REGISTERED  
 150-9002  
 www.cortinaco.com  
 10706 WEST GRAND AVENUE, FRANKLIN PARK, IL 60131

**WARNING CONE 36" TALL**  
**"WET FLOOR" LEGEND AND SYMBOL**

SCALE AT B SIZE	NTS	DRAWING NUMBER	REVISION
DRAFTER	JIL	DATE	7-8-2013
CHECKER	JP	DATE	7-8-2013
		<b>03-600-08</b>	A