

ASSEMBLY INSTRUCTIONS

Cord Locks

Draw String

Draw String
Slots

Peg Slot #1

Peg Slot #2

Peg Slot #1

Peg Slot #2

Tray
Base

Tray Lock



Absorbent
Pad



Complete
Assembly

1

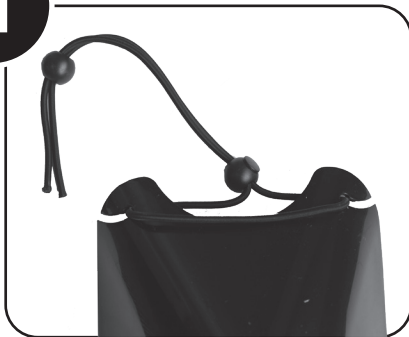

Step 1

Insert Draw String into
Tray Valve Bucket
Draw String Slots.

2

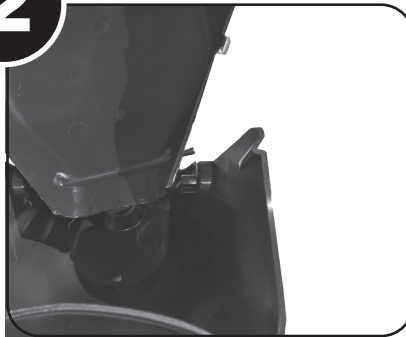

Step 2

Insert Peg #1 into Peg Slot #1.
Pull the Tray Valve Bucket apart
where the Peg Slot #2 extends
past Peg #2 and insert.*

**NOTE: Do not snap Pegs into
Peg Slots as this process may
damage the Pegs.*

3



Step 3

Insert Absorbent Pad into Tray
Base.

Pull Draw String and secure Cord
Lock to Tray Lock for storage, or
continue to Tray installation.